









COMMITTENTE :  
**ASOLO POLIMERI S.R.L.**  
 Via Del Lavoro, 17  
 31011 - Asolo (TV)

**VERIFICA DI ASSOGGETTABILITA' A VIA**  
**TAVOLA 2**  
**- PLANIMETRIA DELLO STABILIMENTO -**

**LEGENDA**

	PERIMETRO AREA RECINTATA
	PERIMETRO AREA TRATTAMENTO RIFIUTI
	IMPIANTO ESTRUSIONE
	BLOCCO UFFICI SPOGLIATOI
	DEPOSITO MATERIALE IN INGRESSO E USCITA
	IMPIANTO TRATTAMENTO RIFIUTI
	DEPURATORE
	PESA A PONTE PER AUTOCARRI
	PIANTUMAZIONE SEMPREVERDE A SIEPE
	ALBERATURE A FOGLIA CADUTA

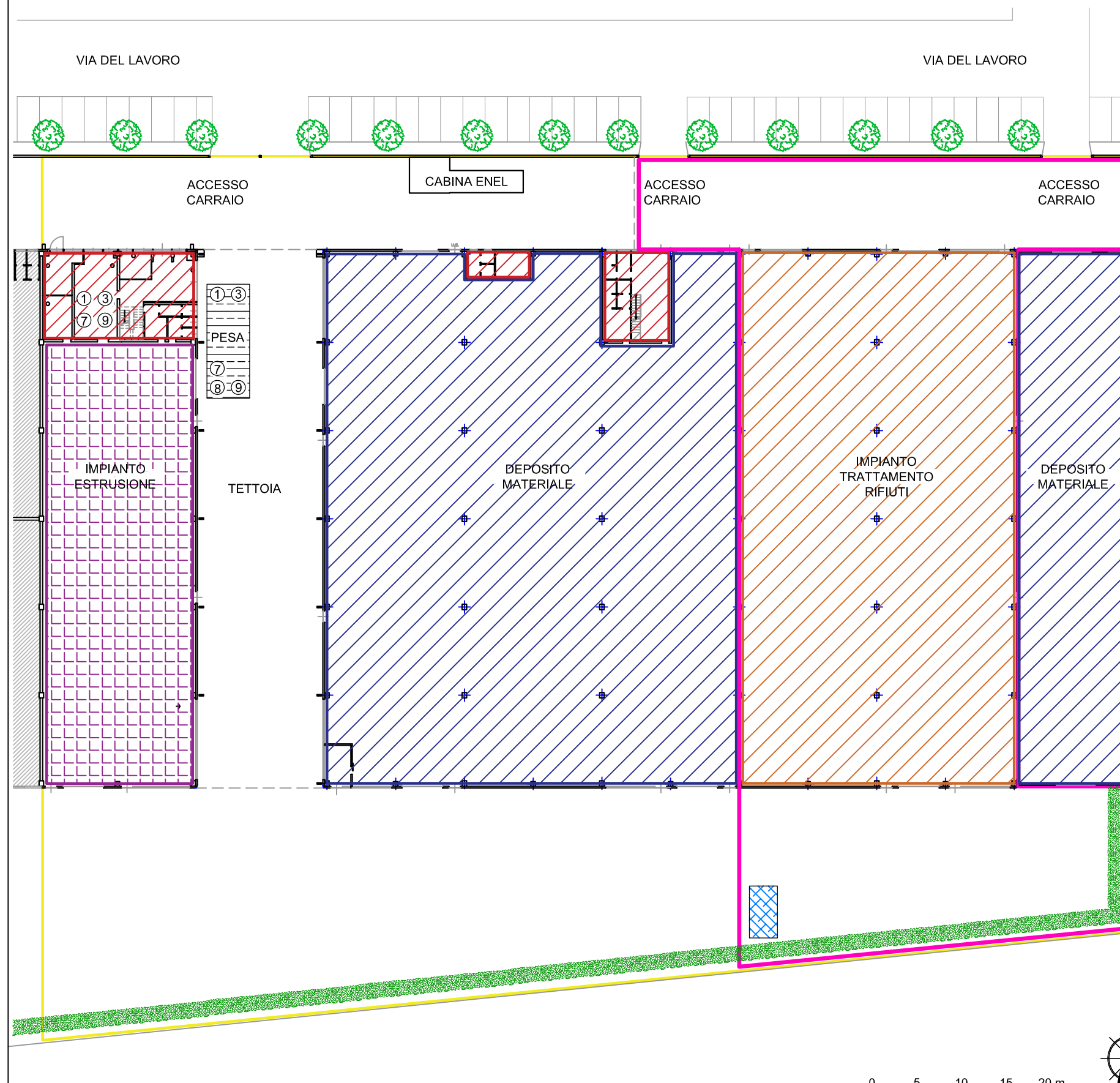

www.sicamconsulting.it

**RECUPERARE E'**  
**MEGLIO CHE**  
**BUTTARE**

**SICAM CONSULTING**  
 Via Roma, n° 19  
 35040 Megliadino S. Vitale (PD)

0 5 10 15 20 m

