

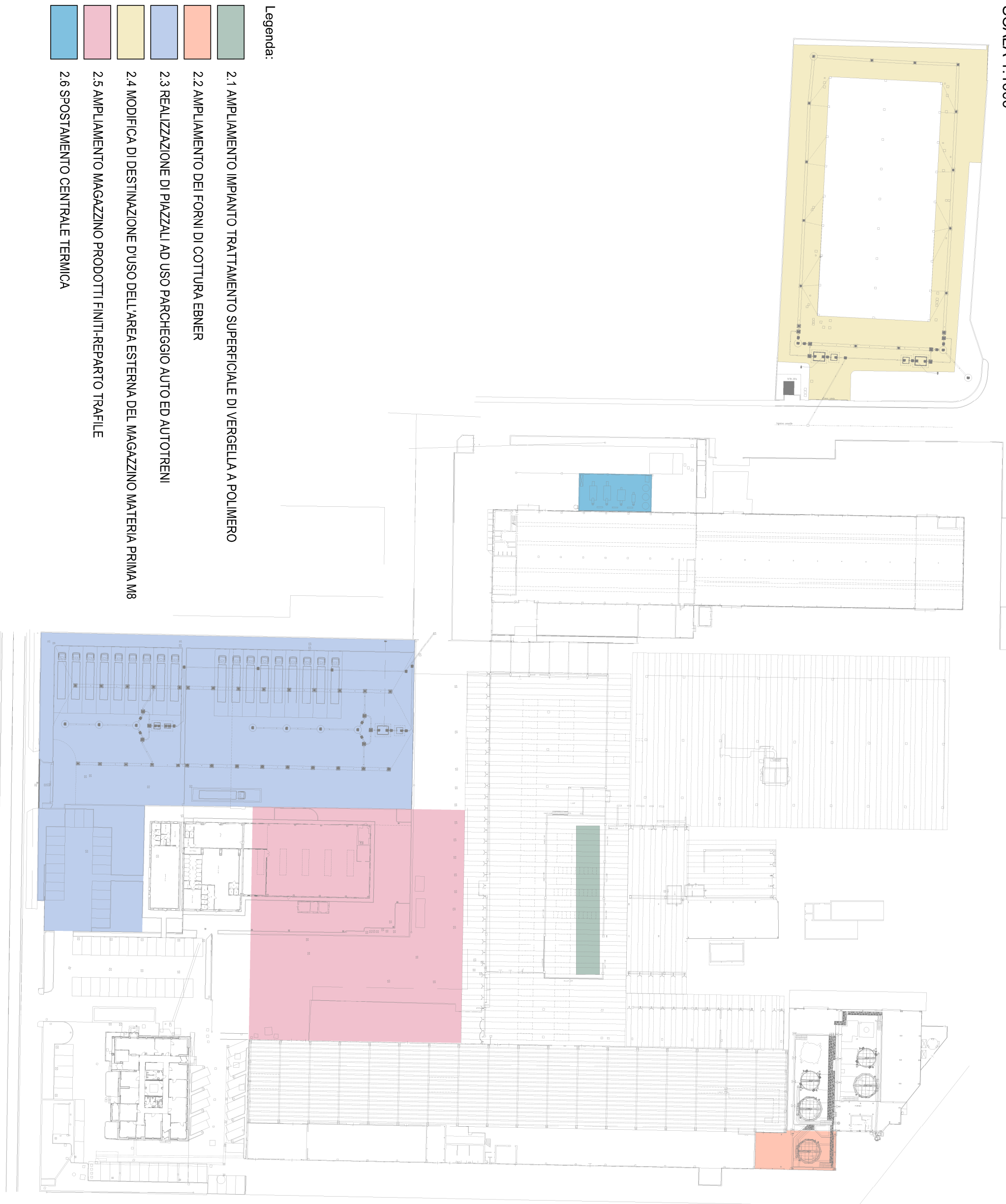





PLANIMETRIA GENERALE

SCALA 1:1000



Legenda:

-  2.1 AMPLIAMENTO IMPIANTO TRATTAMENTO SUPERFICIALE DI VERGELLA A POLIMERO
-  2.2 AMPLIAMENTO DEI FORNI DI COTTURA EBNER
-  2.3 REALIZZAZIONE DI PIAZZALI AD USO PARCHEGGIO AUTO ED AUTOTRENI
-  2.4 MODIFICA DI DESTINAZIONE D'USO DELL'AREA ESTERNA DEL MAGAZZINO MATERIA PRIMA M8
-  2.5 AMPLIAMENTO MAGAZZINO PRODOTTI FINITI-REPARTO TRAFILE
-  2.6 SPOSTAMENTO CENTRALE TERMICA

